

# HONDA

## INSTALLATION INSTRUCTIONS

Accessory  
ENGINE BLOCK HEATER  
P/N 08T44-S10-100

Application  
2001 CR-V

Publications No.  
All 21686  
Issue Date  
OCT 2000

### PARTS LIST

Engine block heater

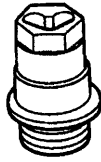

Aluminum washer



Heater harness

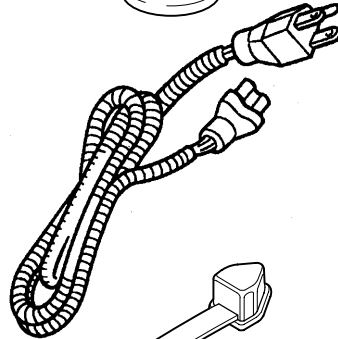

Protective cap

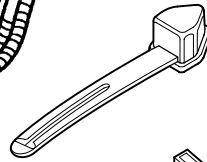

3 Wire ties

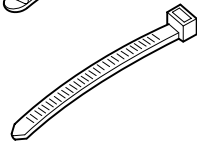

### TOOLS AND SUPPLIES REQUIRED

Drain pan

Breaker bar (1/2" drive)

12 mm, 19 mm, and 24 mm Socket (1/2" drive)

Torque wrench

Diagonal cutters

Coolant (Honda Antifreeze/Coolant only, in a 50/50 solution with water)

### NOTE:

- Always use Honda Antifreeze/Coolant. Using a non-Honda coolant can result in corrosion, causing the cooling system to malfunction or fail.
- To avoid burning out the element, do not operate the engine block heater before it is installed in the vehicle or before you add coolant.

### INSTALLATION

**Customer Information:** The information in this installation instruction is intended for use only by skilled technicians who have the proper tools, equipment, and training to correctly and safely add equipment to your vehicle. These procedures should not be attempted by "do-it-yourselfers."

1. Allow the engine and all cooling system components to cool down.
2. If equipped, make sure you have the anti-theft code for the radio, then write down the frequencies for the preset buttons.
3. Disconnect the negative cable from the battery.
4. Place a clean drain pan under the radiator drain plug; then remove the drain plug from the rear of the radiator to drain the coolant. Remove the radiator cap to increase the flow.

**NOTICE** Radiator coolant will damage paint. Quickly rinse any spilled coolant from painted surfaces.

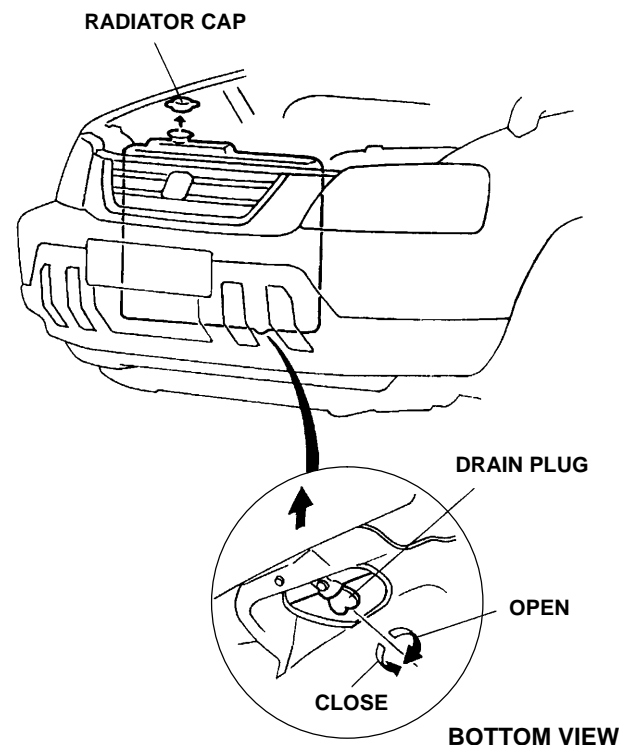

5. Lift the radiator reserve tank from the tank stay, and move it out of the way.

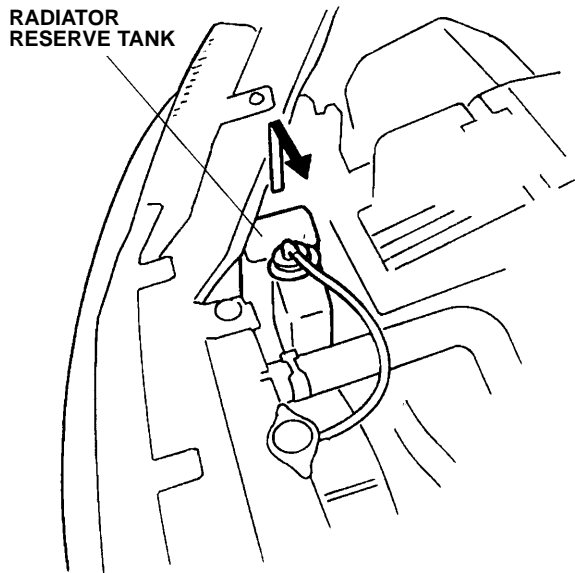

6. Route the heater harness between the right front bulkhead and the radiator and into the engine compartment.

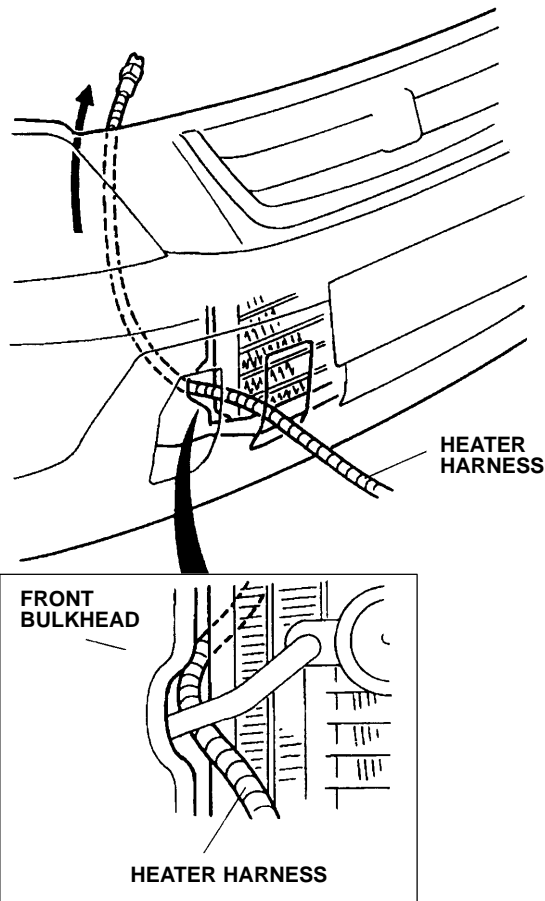

7. Continue routing the heater harness alongside the vehicle harness to the engine drain bolt.

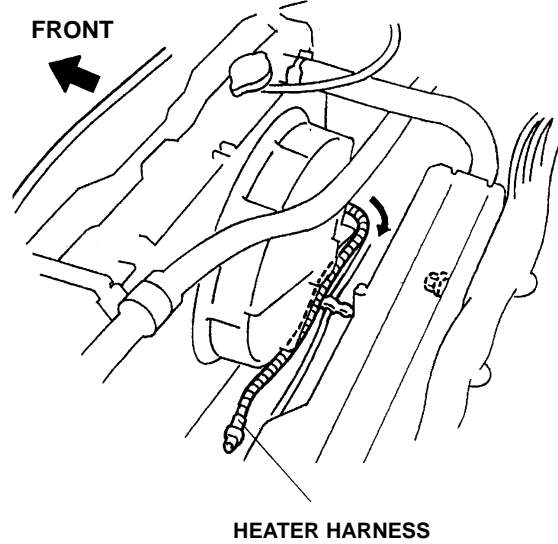

8. Remove the engine drain bolt and the washer from the engine block on the front right side. Coolant remaining in the engine jackets will flow out of the bolt hole when the bolt is removed.

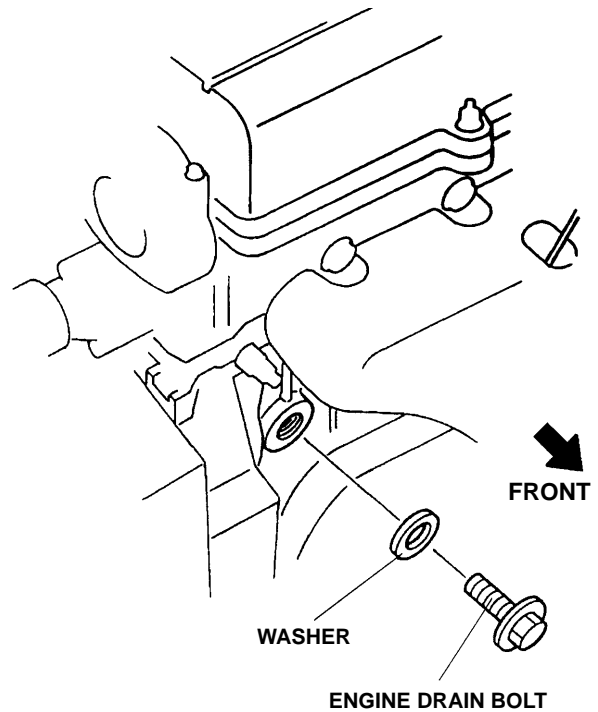

9. Install the new aluminum washer and the engine block heater into the bolt hole using a 24 mm socket and a torque wrench; torque the engine block heater to 60 N·m (44 lb-ft).

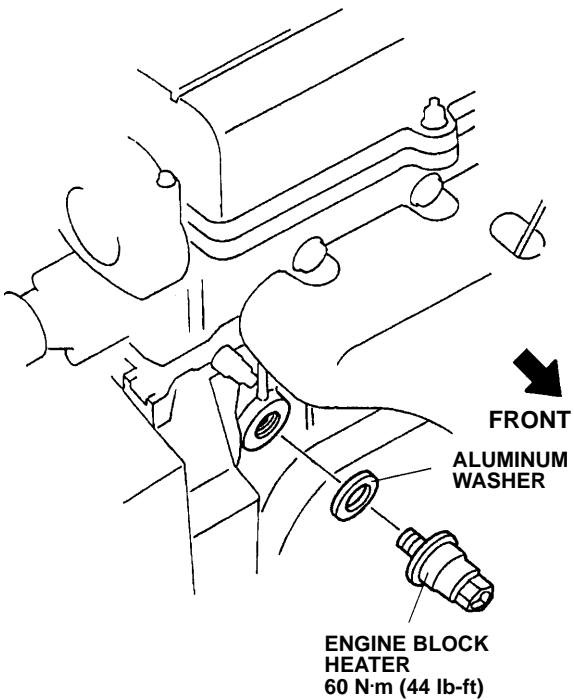

10. Plug the heater harness connector into the engine block heater.

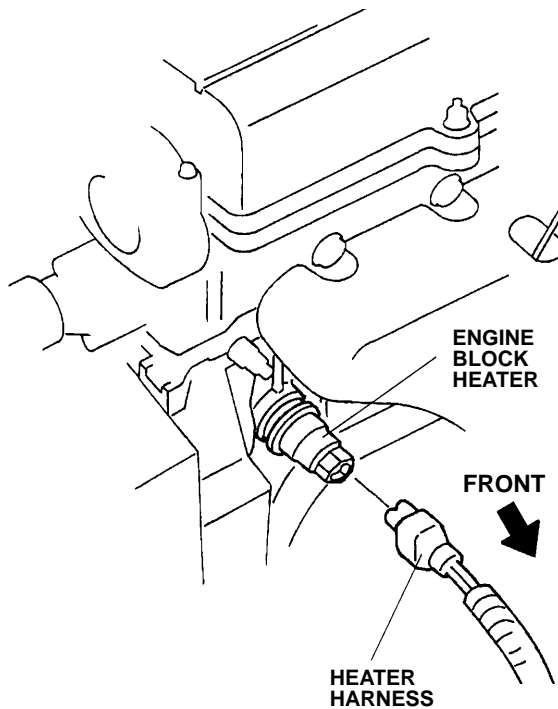

11. Secure the heater harness to the vehicle stay with one wire tie.

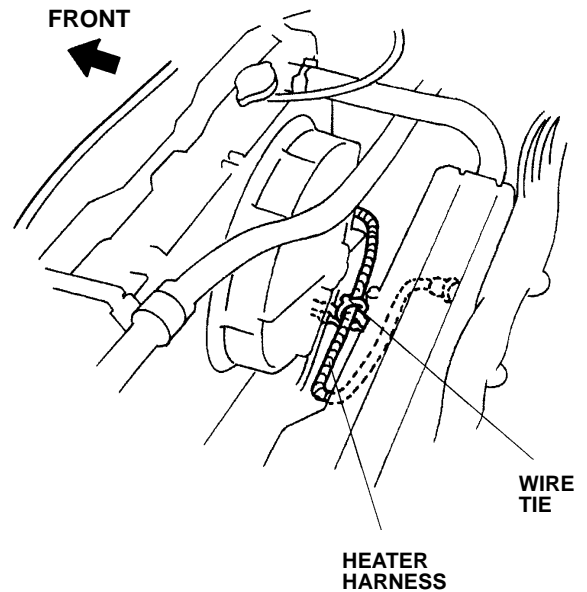

12. Secure the heater harness to the vehicle harness with one wire tie in the area shown.

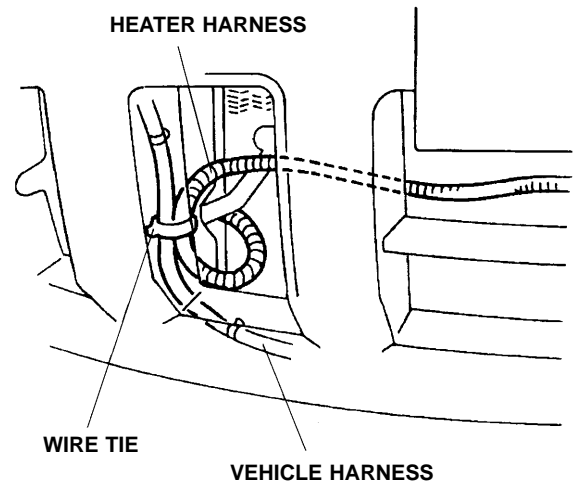

13. Attach the protective cap to the front grille, and plug the connector of the heater harness into the protective cap.

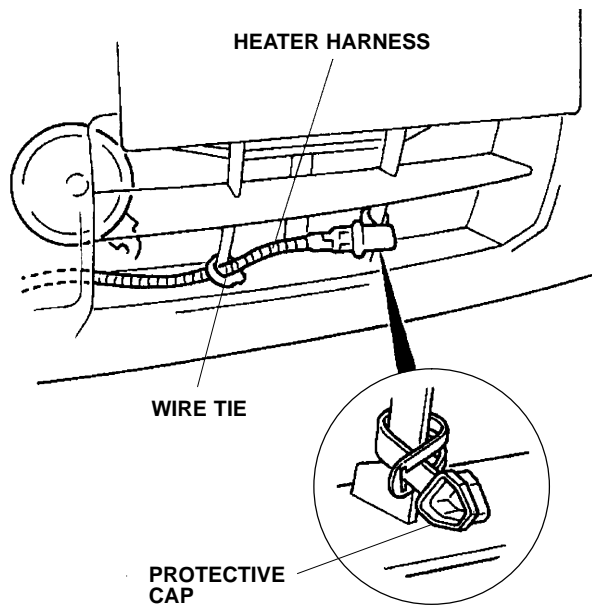

14. Secure the heater harness to the front grille with one wire tie. Use diagonal cutters to cut off the excess end of the wire tie.

15. Reconnect the negative cable to the battery.

16. Fill the system with the recommended coolant.

- Use only Honda Antifreeze/Coolant mixed 50/50 with water.
- Start the engine, and let it idle for about 10 minutes.
- Stop the engine, and recheck the level of the coolant. If necessary, replenish the coolant up to the proper level.
- Repeat the above procedures until the correct coolant level is obtained.

17. Check the coolant reservoir for correct level and signs of leakage. Repair as necessary.

18. If equipped, enter the customer's radio anti-theft code, then reset the radio station preset buttons.

19. Reset the clock.